



ENGINEERING



Loewen & Provincial Trunk Highway (PTH) 12 Intersection Improvements

City of Steinbach

Manitoba Transportation & Infrastructure

WWW.STEINBACH.CA
@CITYOFSTEINBACH

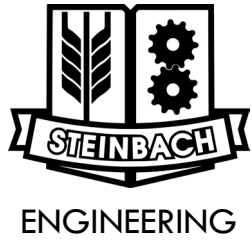

Introductions

City of Steinbach

- Aaron Rach, P.Eng.
- Bea Krahn

City Engineer

Communications Coordinator

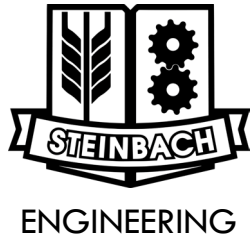

Project Information

Project Owners:



Consultant:



Contractor:





ENGINEERING

Project Information

Tendered Cost: \$9,981,284.00

Jointly funded by Manitoba Transportation & Infrastructure and the City of Steinbach

Includes:

- ~700m of water main replacement
- ~900m of wastewater sewer replacement
- ~570m of land drainage sewer replacement
- Total reconstruction of the intersection
- Conversion of Hydro servicing from overhead to underground



ENGINEERING

Purpose of Project

Improve the intersection's level of service

- Decreased wait times

Replacement of aged infrastructure

- Existing underground infrastructure is nearing the end of it's service life
 - Renewing this infrastructure now will minimize overall costs and decrease the number of times construction impacts this area.

Select water and wastewater pipes will be upsized to improve overall system capacities.



ENGINEERING

Construction Limits

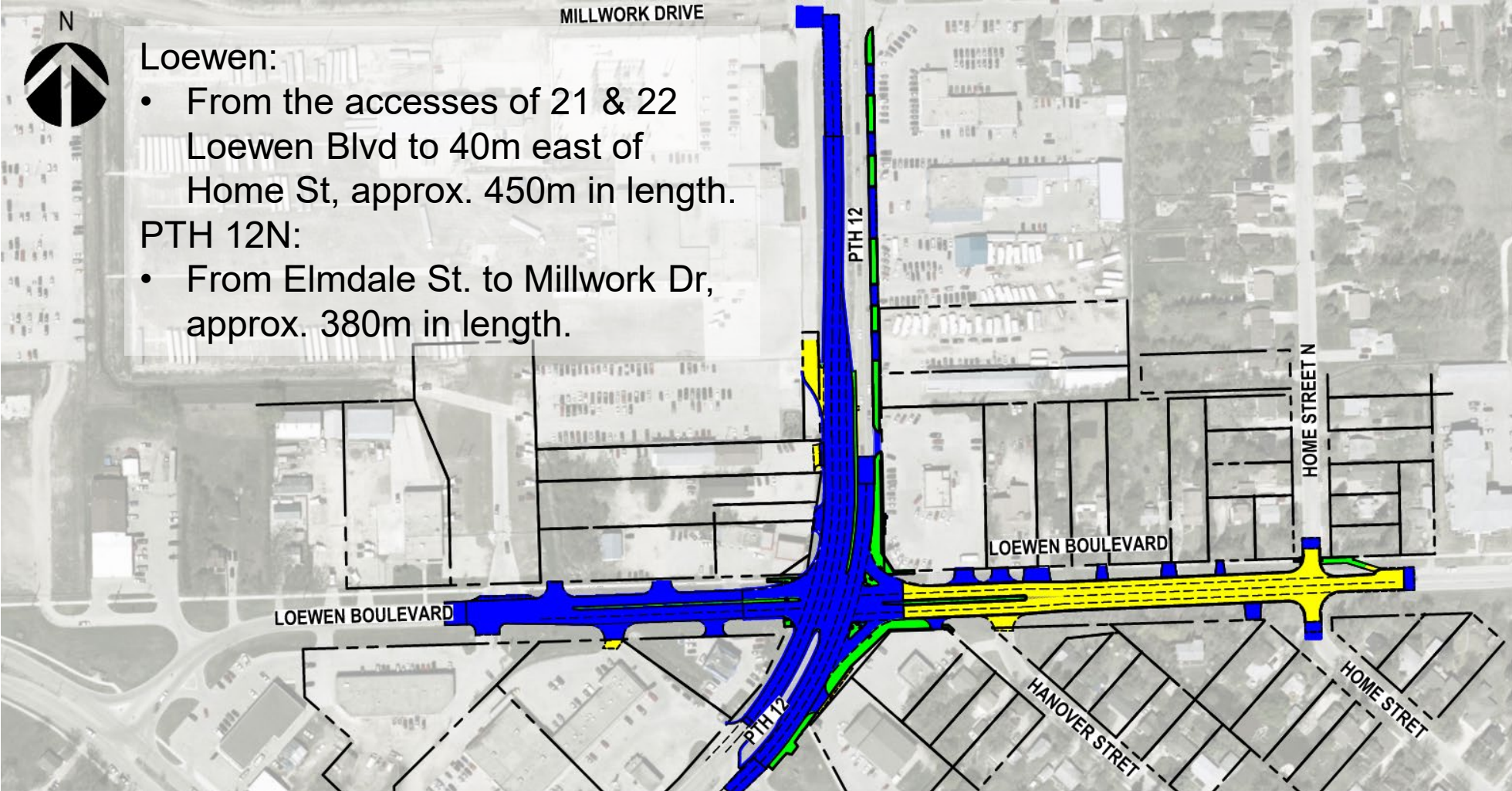



ENGINEERING

Intersection Improvements

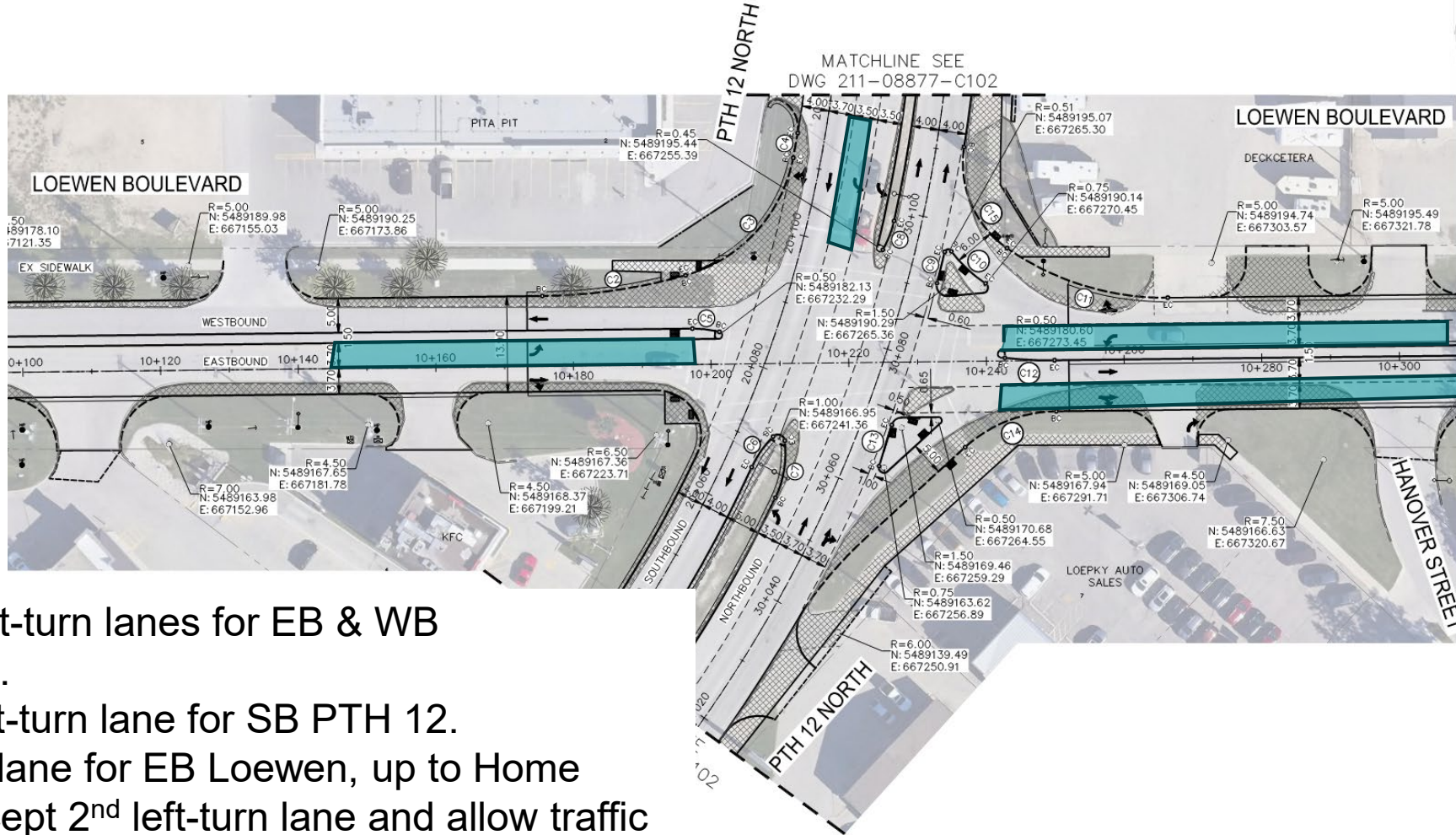

Traffic Flow

- Dedicated left-turn lanes for EB & WB Loewen Blvd.
- Additional left-turn lane for SB PTH 12.
- Acceleration lane for EB Loewen, up to Home Street, to accept 2nd left-turn lane and allow traffic to merge to single lane



ENGINEERING

Intersection Improvements

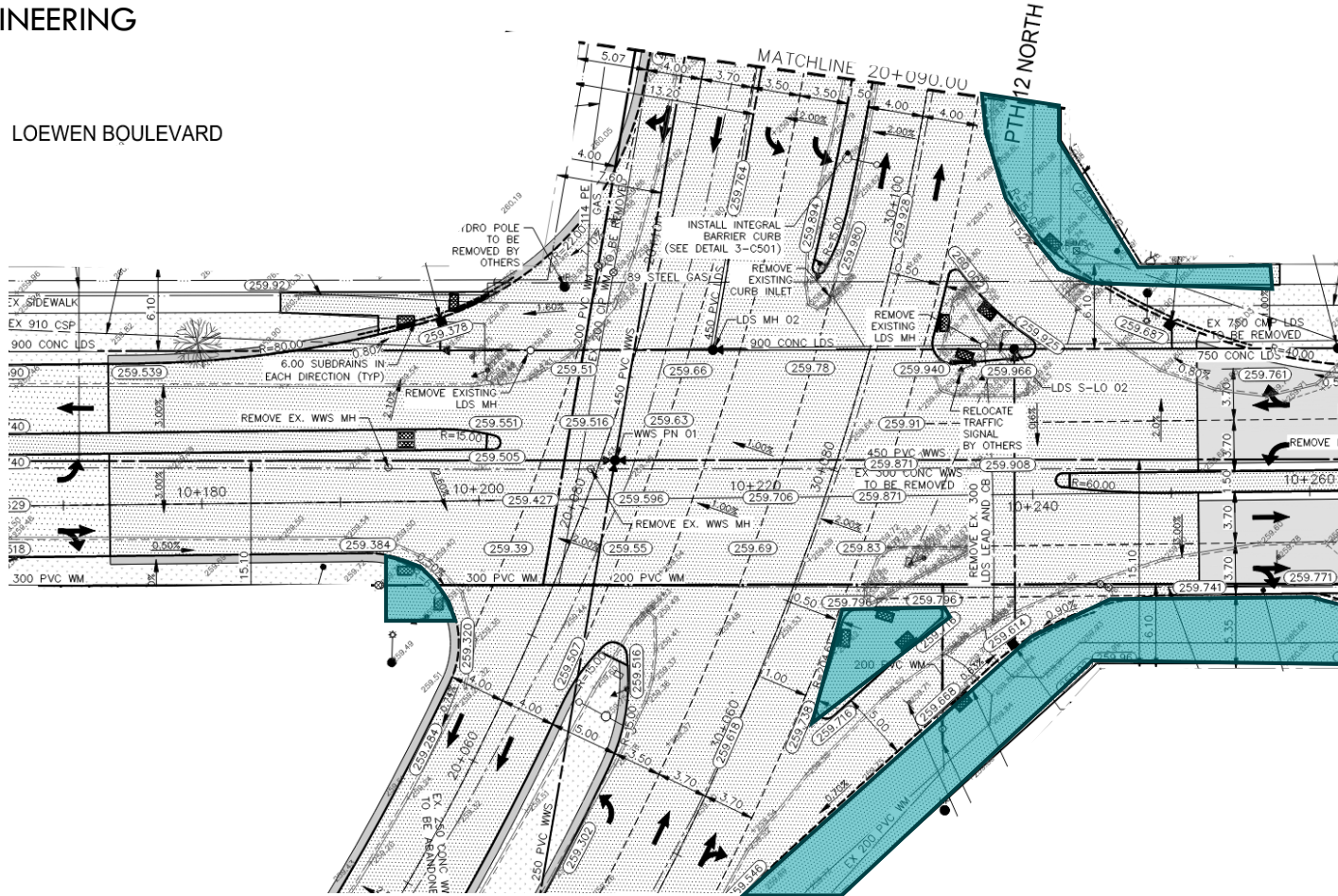

Pedestrian Improvements:

- Increased size of SE yield island and concrete surfacing of the NE & SE corner boulevards to provide more space for pedestrians.
- Installation of detectable warning tiles.
- Addition of pedestrian refuge at SW boulevard.
- Relocation of traffic signal poles to outside of walking paths.



ENGINEERING

Intersection Improvements

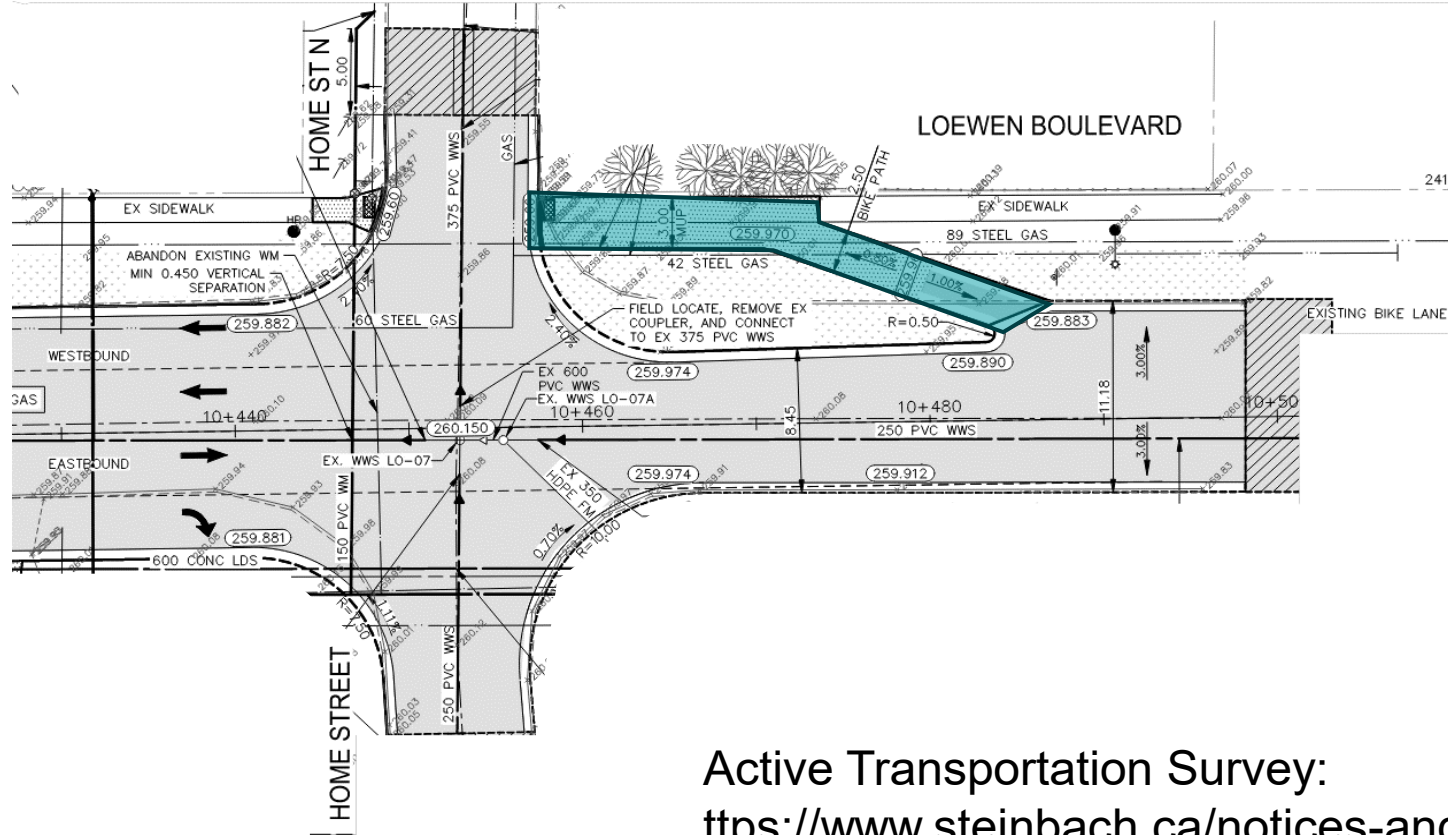

Active Transportation:

- Existing bike lane merges to an active transportation pathway at Home St.
- Pathway will be widened along PTH 12 east boulevard, from Loewen Blvd to Stonebridge Crossing

Active Transportation Survey:
<https://www.steinbach.ca/notices-and-announcements/share-your-thoughts-active-transportation-plan/>



ENGINEERING

Intersection Improvements

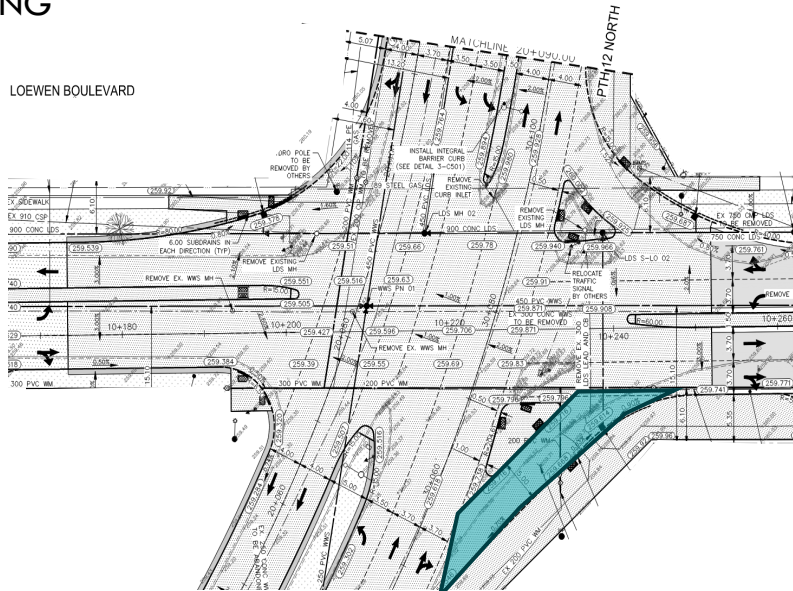

LOEWEN BOULEVARD

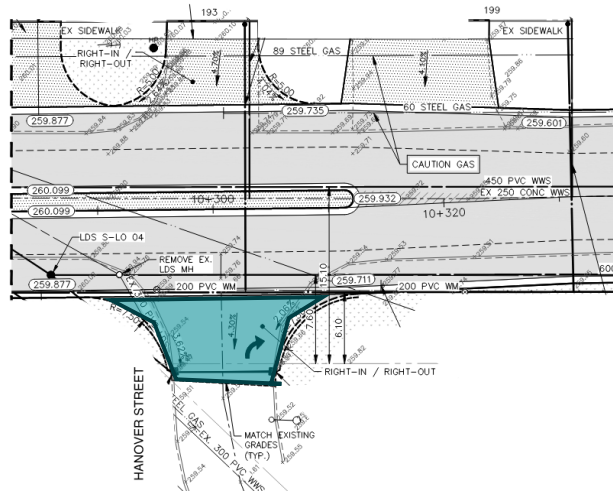

HANOVER STREET

Safety Improvements:

- Constructing a “smart channel” for the right-turn yield from NB PTH 12 to Loewen Blvd.
- Encourages lower vehicle speed for the safety of pedestrians crossing.
- Converting from overhead hydro lines to underground.
- Hydro poles are removed from the intersection, eliminating the chance of vehicles colliding with the poles.
- Removing NB Hanover Street left-turn onto Loewen Boulevard.
- The Hanover St intersection is very close to PTH 12. With the addition of a centre median, acceleration lane and left-turn lane to Loewen Boulevard, the intersection would not operate safely if this movement was still allowed.

Intersection Improvements

Environmental Improvements:

- Soil remediation is planned for any contaminated soil that is encountered.
- There were formerly gas stations surrounding this intersection so any contaminated soils that are encountered will be sent off-site to a remediation facility.



ENGINEERING

Staging Plan: Phase 1

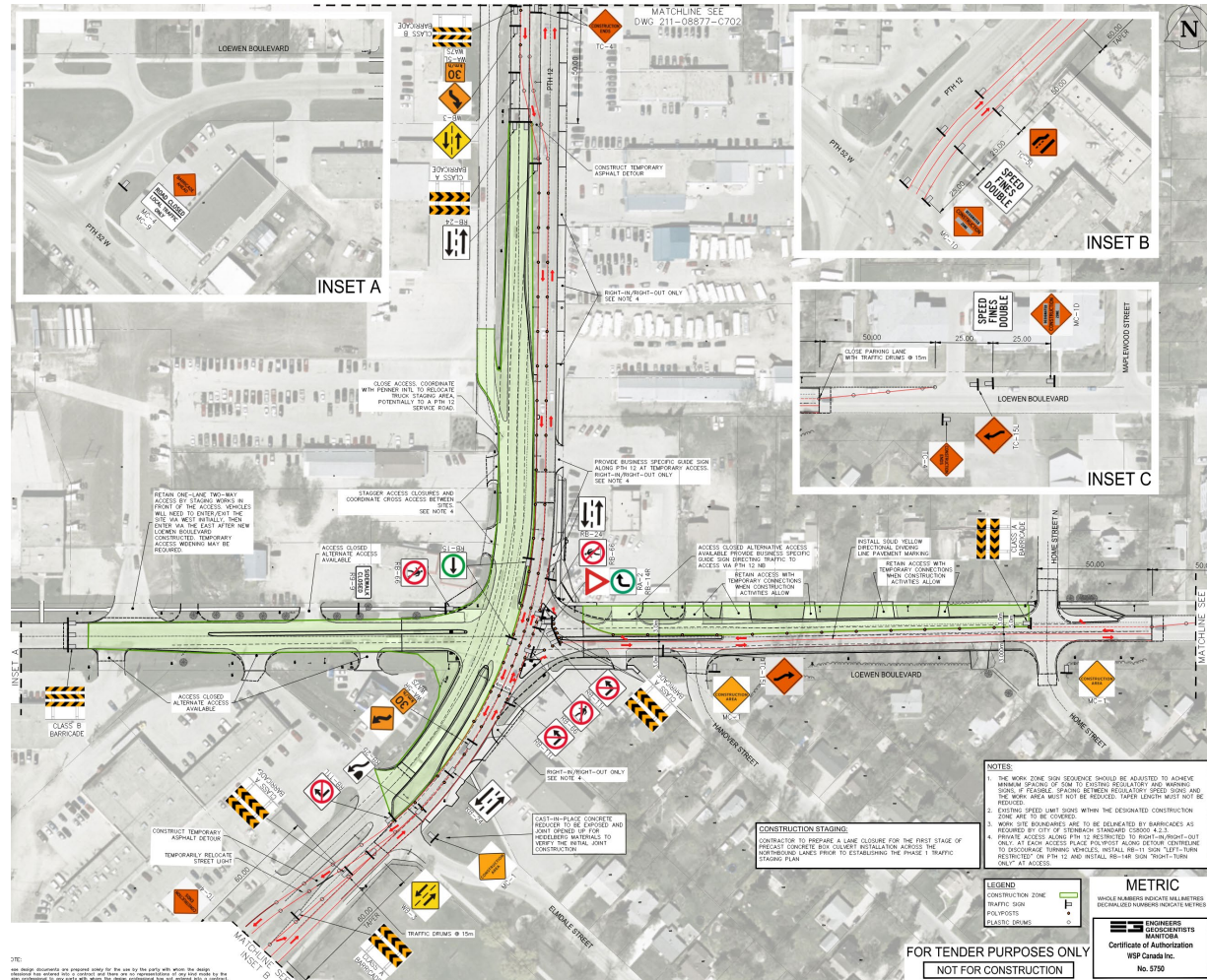

Preliminary Plan:

- **Scheduled Start Date:** June 17, 2024
- SB traffic will be redirected to the east side of the highway north of Millwork Drive and then back to the west side at Elmdale Street.
- Traffic lights at the intersection will be disabled
- WB Loewen traffic will be redirected to the south side of the road
- Loewen Blvd between Penner International and PTH 12 will be fully closed.

Detour Plan: Phase 1



Loewen & PTH 12 Intersection Reconstruction



Staging Plan: Phase 2

ENGINEERING

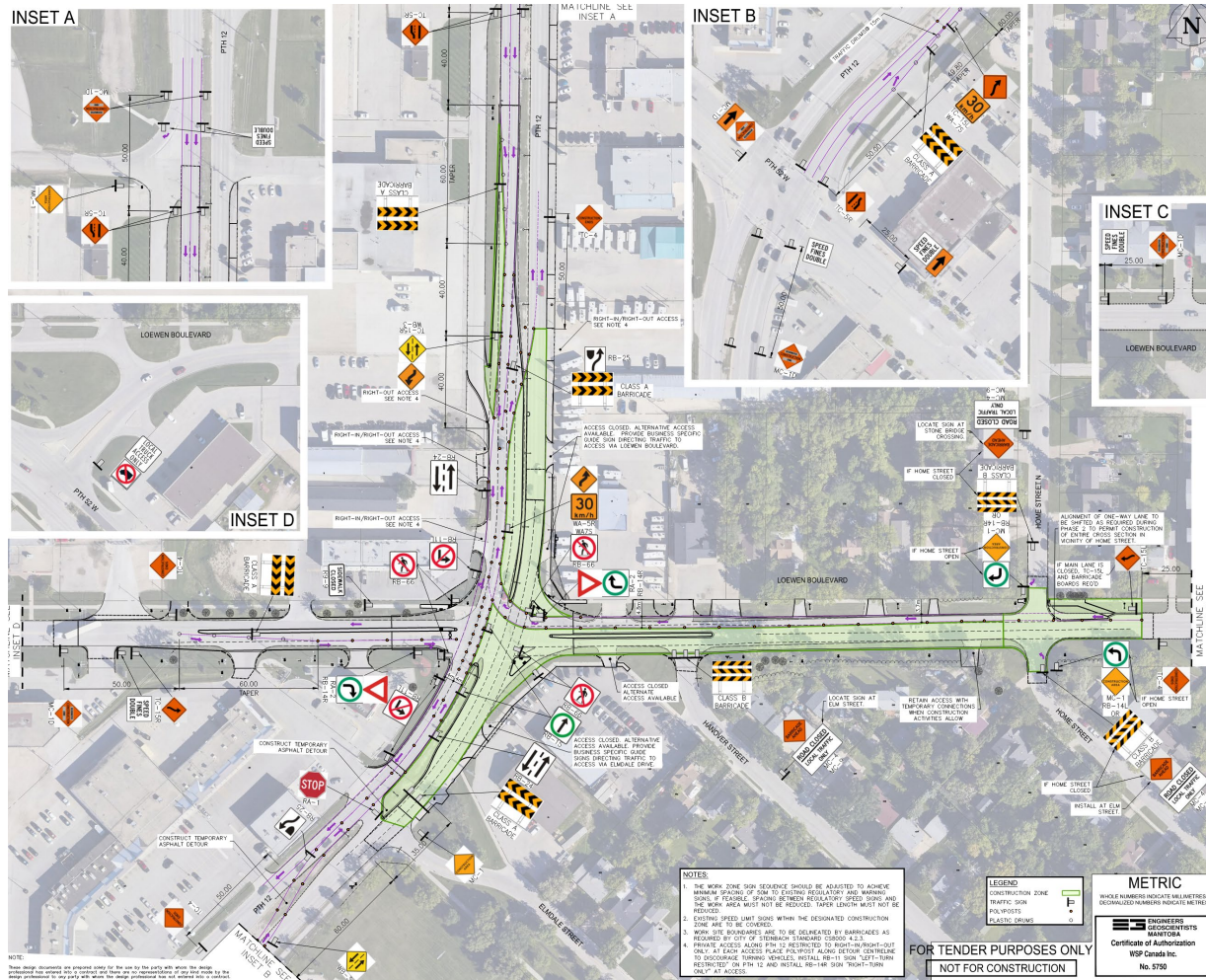

Preliminary Plan:

- Northbound lanes will be reconstructed, Loewen east of PTH 12, and any remaining underground work.
- Northbound traffic will be redirected to use one lane of southbound PTH 12.
- Traffic lights at the intersection will still be inactive.
- Loewen Blvd between Home St & PTH 12 will be down to one lane.
- **Scheduled Completion Date:** End of July or beginning of August 2025



ENGINEERING

Detour Plan: Phase 2

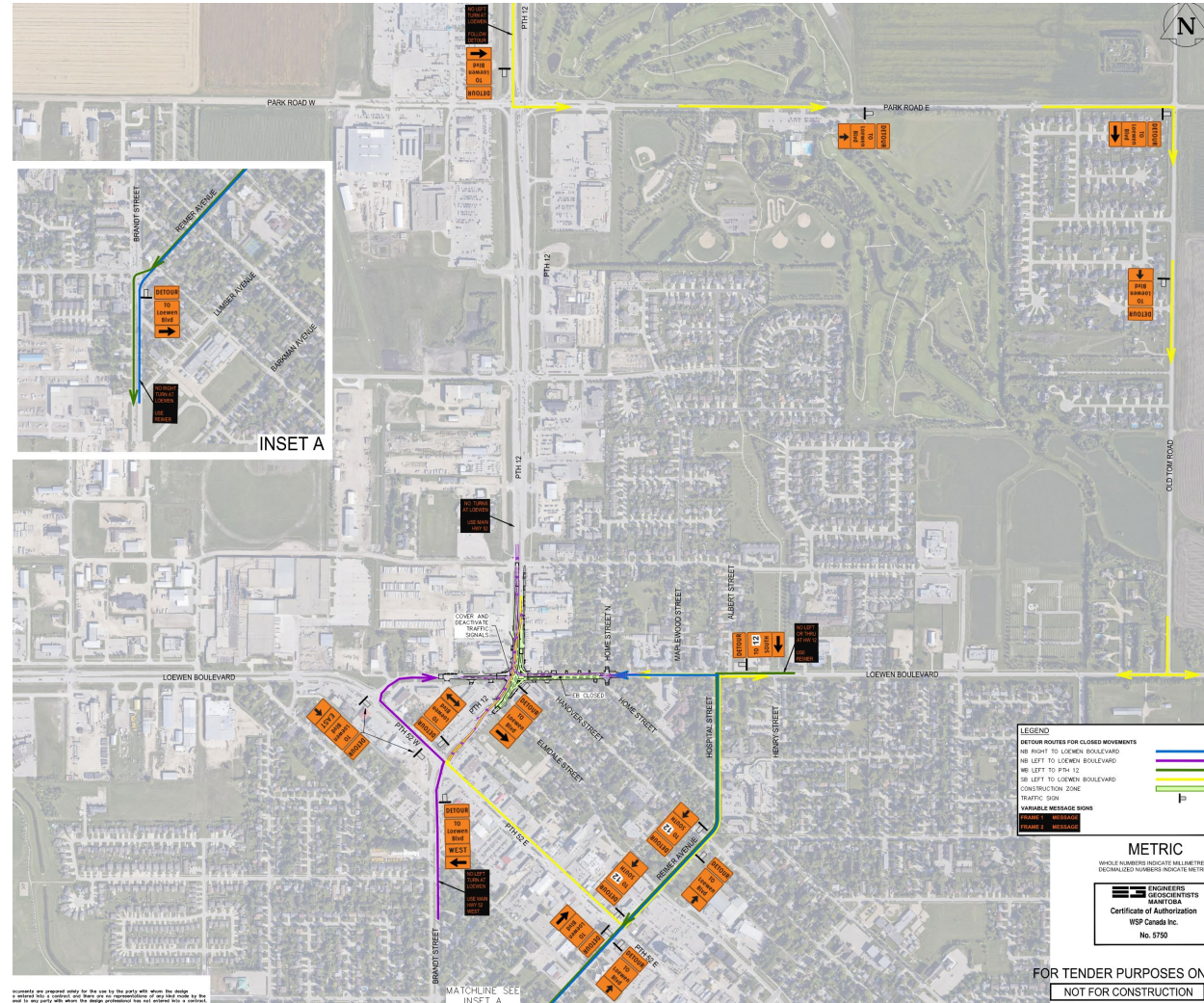

Loewen & PTH 12 Intersection Reconstruction

WWW.STEINBACH.CA
@CITYOFSTEINBACH

Community Impacts

Traffic Delays

Increase in traffic along detour routes

Limited access to homes & businesses.

Temporary water service to affected properties.
- 24-hour notice will be given for any shutdowns required.



ENGINEERING

Community Benefits

Improved intersection geometry

Improved traffic flow through intersection

Increase in water and wastewater system capacity

Replacement of aged infrastructure



ENGINEERING

Contact Information

Your cooperation and patience during construction will be appreciated. Please contact the City of Steinbach Engineering Department if you have any comments or concerns.

City of Steinbach Engineering Department Contacts:

Aaron Rach, P.Eng.
City Engineer
204.346.6578
aaron.rach@steinbach.ca

Russ Mehling, C.E.T.
Engineering Technologist
204.346.6577
russ.mehling@steinbach.ca



ENGINEERING

Project Updates

Visit the City's website or follow the City on social media for more information on the project or updates as the project progresses. Scan the QR code to visit our website, www.steinbach.ca, and to find links to our social media pages.





ENGINEERING

Questions?
